

data sheet

ARGCO



WALL HANGER BRACKETS



- Galvanized steel construction - *Includes end caps*
- C profile with continuous perforation
- Ideally suited as a load-bearing cantilever bracket
- Stable construction due to solid base plate
- Slotted holes in the base plate allows height adjustment
- Can be used as a cantilever bracket for air conditioners, air ducts & cable trays



Item #	Profile	H	W	C
2540560	1-3/16" x 13/16" x 12" long (30x20x300mm)	4-3/4"	1-9/16"	3-1/8"
2540561	1-3/16" x 1-3/16" x 9" long (30x30x250mm)	4-3/4"	1-9/16"	3-1/8"
2540562	1-3/16" x 1-3/16" x 12" long (30x30x300mm)	4-3/4"	1-9/16"	3-1/8"
2540563	1-3/16" x 1-3/16" x 16" long (30x30x400mm)	4-3/4"	1-9/16"	3-1/8"
2540564	1-1/2" x 1-5/8" x 9.5" long (38x40x240mm)	4-3/4"	1-9/16"	3-1/8"
2540565	1-1/2" x 1-5/8" x 16" long (38x40x440mm)	4-3/4"	1-9/16"	3-1/8"
2540566	1-1/2" x 1-5/8" x 19" long (38x40x480mm)	4-3/4"	1-9/16"	3-1/8"
2540567	1-1/2" x 1-5/8" x 25" long (38x40x640mm)	4-3/4"	1-9/16"	3-1/8"

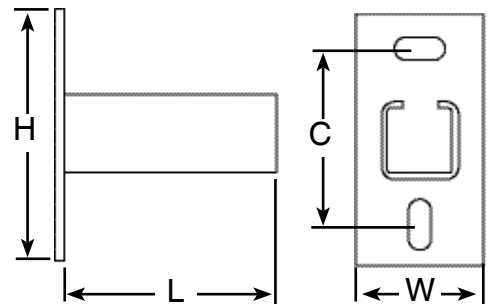

*for locking slide bolt (2540548)



**FOR MORE INFORMATION
CALL ARGCO AT
800-854-1015
OR LOG ONTO
ARGCO.COM**

Item #	Profile	MAX. RECOMMENDED LOAD (LBS)			
		↕	↔	↕↔	↕↔↔
2540560	1-3/16" x 13/16" x 12" long (30x20x300mm)	78	32	39	26
2540561	1-3/16" x 1-3/16" x 9" long (30x30x250mm)	296	148	148	98
2540562	1-3/16" x 1-3/16" x 12" long (30x30x300mm)	230	110	110	74
2540563	1-3/16" x 1-3/16" x 16" long (30x30x400mm)	176	88	88	58
2540564	1-1/2" x 1-5/8" x 9.5" long (38x40x240mm)	688	344	344	229
2540565	1-1/2" x 1-5/8" x 16" long (38x40x440mm)	411	205	205	137
2540566	1-1/2" x 1-5/8" x 19" long (38x40x480mm)	343	171	171	114
2540567	1-1/2" x 1-5/8" x 25" long (38x40x640mm)	256	105	105	85

