

## SPRING LOADED CHECK VALVE

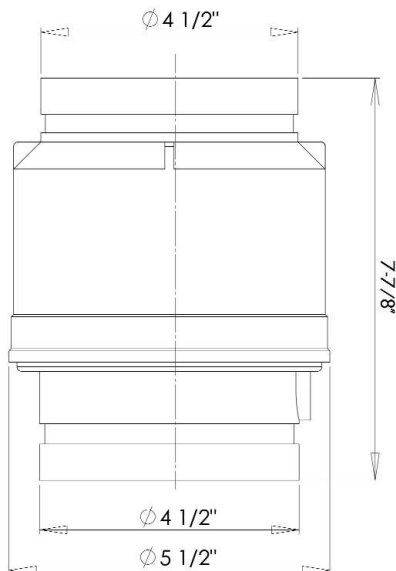

Used to prevent reverse water flow into Fire Protection Systems

- 300 p.s.i. rated pressure
- Vertical or horizontal installation
- Spring loaded
- UL/ULC and FM Approved



**6510210BR:** 4" groove x groove  
spring loaded check valve  
Finish: rough brass

**6510210-TG:** 4" groove x (Male) NPT  
spring loaded check valve  
Finish: rough brass

**6510210-THREAD:** 4" Male NPT Inlet x Female NPT outlet  
spring loaded check valve  
Finish: rough brass

The information contained herein is produced in good faith and is believed to be reliable but is for guidance only. ARGCO and its agents cannot assume liability or responsibility for results obtained in the use of its product by persons whose methods are outside or beyond our control. It is the user's responsibility to determine the suitability of any of the products, methods of use, or preparation prior to use, mentioned in our literature. It is the user's responsibility to observe and adapt such precautions as may be advisable for the protection of personnel and property in the handling and use of any of our products.

**FOR MORE INFORMATION CALL ARGCO AT 1-800-854-1015  
OR LOG ONTO WWW.ARGCO.COM**