

# data sheet

## ARGCO



### DROP IN ANCHORS



- For use in concrete, stone
  - Use with machine screw, bolt or threaded rod
  - Made of zinc plated steel
  - Layout or hole spotting required
  - Internal plug, pre-assembled
  - Screw engagement minimum 2/3 of thread depth
  - For flush mounted installations
  - One piece pre-assembled construction
- Setting tool sold separately*

#### CROSS REFERENCE

Item #	THREAD SIZE	ANCHOR LENGTH	ALLOWABLE PULL-OUT LOAD	SETTING TOOL Item #
25-35-100	1/4"-20	1" (2mm)	635#	25-35-111
25-35-101	3/8"-16	1-9/16" (40mm)	1170 #	25-35-107
25-35-105	3/8"-16	3/4" (19 mm)	1170#	25-35-106
25-35-102	1/2"-13	2" (51 mm)	1883 #	25-35-108
25-35-103	5/8"-11	2-1/2" (64 mm)	2434 #	-
25-35-104	3/4"-10	3-1/8" (79 mm)	2754 #	25-35-110

Item #	THREAD SIZE	B-LINE®
25-35-100	1/4"-20	ADI-25
25-35-101	3/8"-16	ADI-37
25-35-102	1/2"-13	ADI-50
25-35-103	5/8"-11	ADI-62
25-35-104	3/4"-10	ADI-75

Drop in anchors available stainless steel

Drop in setting tool

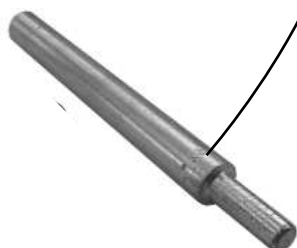

The information contained herein is produced in good faith and is believed to be reliable but is for guidance only. ARGCO and its agents cannot assume liability or responsibility for results obtained in the use of its product by persons whose methods are outside or beyond our control. It is the user's responsibility to determine the suitability of any of the products, methods of use, or preparation prior to use, mentioned in our literature. It is the user's responsibility to observe and adapt such precautions as may be advisable for the protection of personnel and property in the handling and use of any of our products.

**FOR MORE INFORMATION CALL ARGCO AT 1-800-854-1015  
OR LOG ONTO WWW.ARGCO.COM**

# data sheet

## **ARGCO**



### **DROP IN ANCHORS**



Drop In Anchor  
& Setting Tool

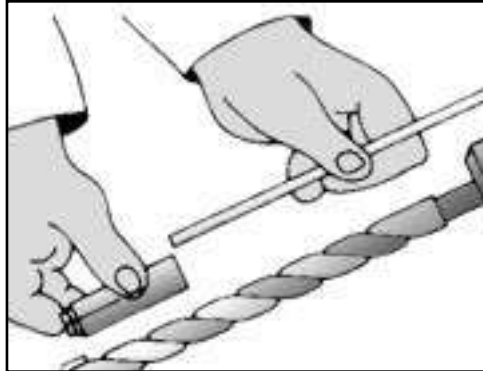

1. Adjust depth gauge so anchor will be flush with the base material surface.

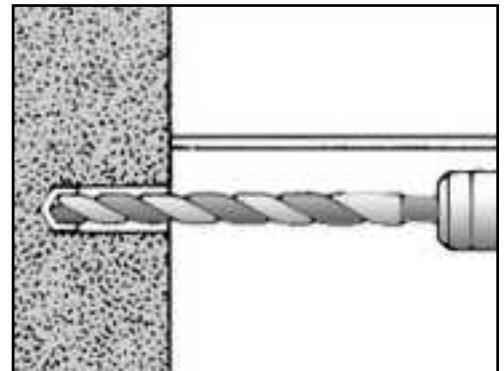

2. Hammer-drill the hole.

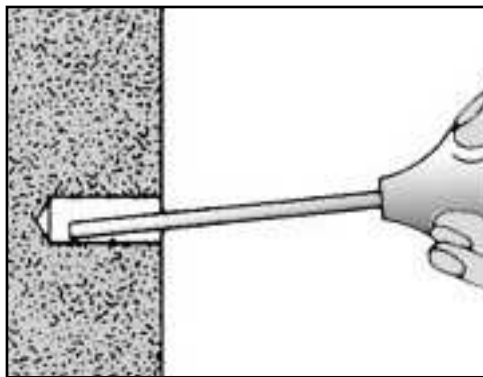

3. Clean hole.

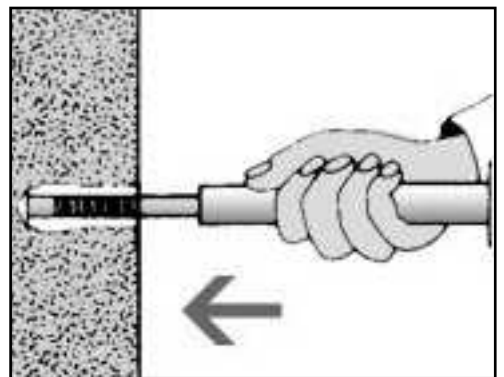

4. Install anchor using proper setting tool. Setting tool to be driven into anchor until setting tool shoulder meets top of anchor.

### **Drop-in Anchor Installation**

Drill hole into concrete with a carbide tipped masonry drill bit, matching the bit size with the outside diameter of the drop-in anchor being used.

Make sure hole depth exceeds minimum embedment.

Clean out concrete dust from hole using a wire brush, compressed air or a blow out bulb.

Drive anchor into hole flush with the surface of the concrete.

Using the proper setting tool for the anchor, expand anchor by inserting the setting tool into the anchor and set with several solid hammer blows. The anchor is set properly when shoulder of setting tool is flush with the top of anchor.

To set anchor below surface: Drill hole deeper than anchor length.

Thread bolt into anchor.

Hammer anchor into hole until bolt head is a desired depth.

Remove bolt and set anchor with setting tool as described above.

**FOR MORE INFORMATION CALL ARGCO AT 1-800-854-1015  
OR LOG ONTO [WWW.ARGCO.COM](http://WWW.ARGCO.COM)**