

# data sheet

## **ARGCO**

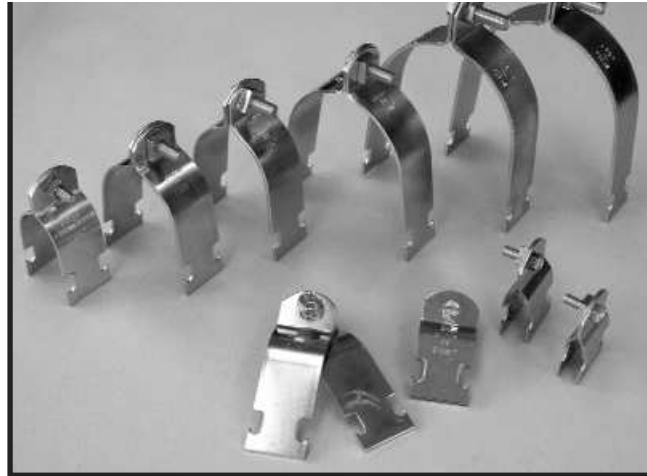

### STRUT CLAMPS



#### STRUT CLAMPS For Rigid Pipe

- Pre-assembled with combo machine slot screw and nut.
- Twist inserted anywhere along the slot side of strut.
- Fits standard US Strut Shallow & Deep (1-5/8" wide)
- Zinc plated steel construction

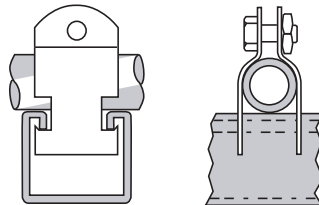

ITEM #	PIPE SIZE O.D.	IPS		MAX. LOAD CAP.
		IPS	CPS	
25-50-400	5/8"	3/8"	1/2"	400
25-50-401	7/8"	1/2"	3/4"	400
25-50-402	1-1/8"		1"	600
25-50-403	1-3/8"	1"	1-1/4"	600
25-50-404	1-5/8"	1-1/4"	1-1/2"	600
25-50-405	1-7/8"	1-1/2"		600
25-50-406	2-1/8"		2"	800
25-50-407	2-3/8"	2"		800
25-50-408	2-5/8"		2-1/2"	800
25-50-409	2-7/8"	2-1/2"		800
25-50-410	3-1/8"		3"	1000
25-50-411	3-1/2"	3"		1000
25-50-412	4-1/8"	3-1/2"	4"	1000
25-50-413	4-1/2"	4"		

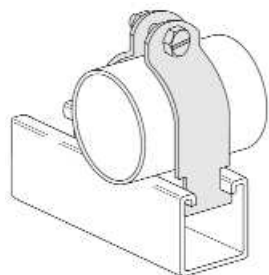

#### STRUT CLAMPS FOR EMT

- Pre-assembled with combo machine slot screw and nut.
- Twist inserted anywhere along the slot side of strut.
- Fits US Strut Shallow & Deep (1-5/8" wide)
- Zinc plated steel construction

EMT SIZE	O.D. SIZE	MAX. LOAD CAPACITY
1/2"	0.706"	400
3/4"	0.922"	600
1"	1.163"	600
1-1/4"	1.510"	600
1-1/2"	1.740"	800
2"	2.197"	800

The information contained herein is produced in good faith and is believed to be reliable but is for guidance only. ARGCO and its agents cannot assume liability or responsibility for results obtained in the use of its product by persons whose methods are outside or beyond our control. It is the user's responsibility to determine the suitability of any of the products, methods of use, or preparation prior to use, mentioned in our literature. It is the user's responsibility to observe and adapt such precautions as may be advisable for the protection of personnel and property in the handling and use of any of our products.

**FOR MORE INFORMATION CALL ARGCO AT 1-800-854-1015  
OR LOG ONTO WWW.ARGCO.COM**